

REVISIONS	
REV #	
DATE	

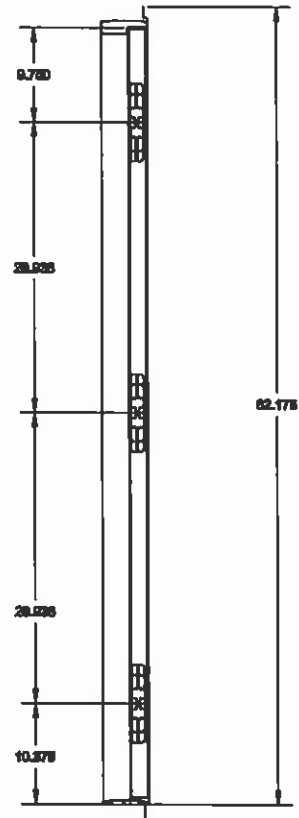
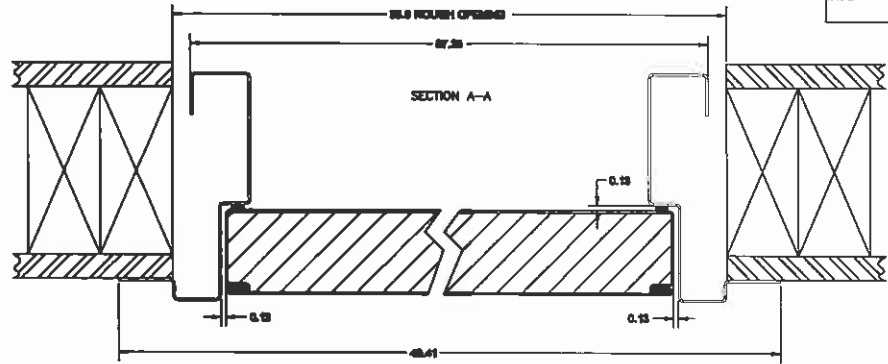
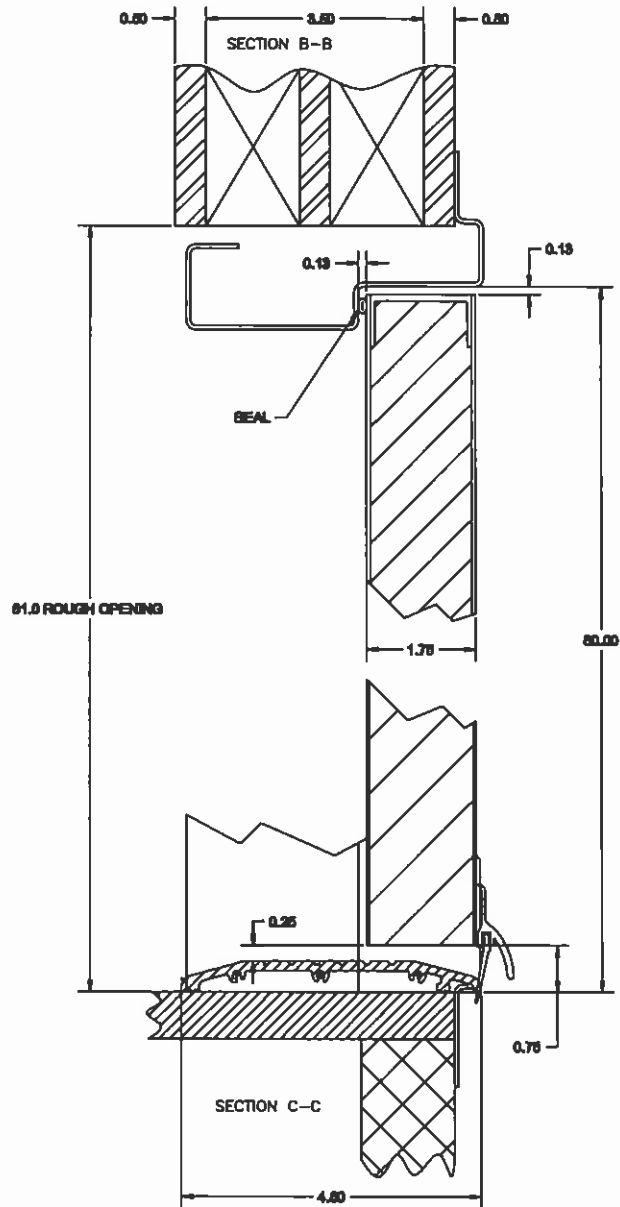

pg. 2 of 3

STANDARD TOLERANCE		FINISH		MATERIAL		DATE		REVISIONS	
0.0	± .030	ROUGH	SMOOTH	STEEL	ALUMINUM	DATE		3088 TELSTAR PRO DOOR DETAILS	
0.00	± .000	FINISH REQUIREMENTS OF THIS DRAWING		FINISH		DATE			
0.000	± .005	FINISH REQUIREMENTS OF THIS DRAWING		FINISH		DATE			
0.0000	± .0005	FINISH REQUIREMENTS OF THIS DRAWING		FINISH		DATE			
ANGULAR DIM. 1/2		ALL DIM. IN DECIMAL UNLESS OTHERWISE INDICATED		TELL MANUFACTURING, INC.		DATE		B. BOMBERGER	
FRAC.DIM.TOL. 1/32						DATE		MMD10100	